

4 LEAN

4D Fixture

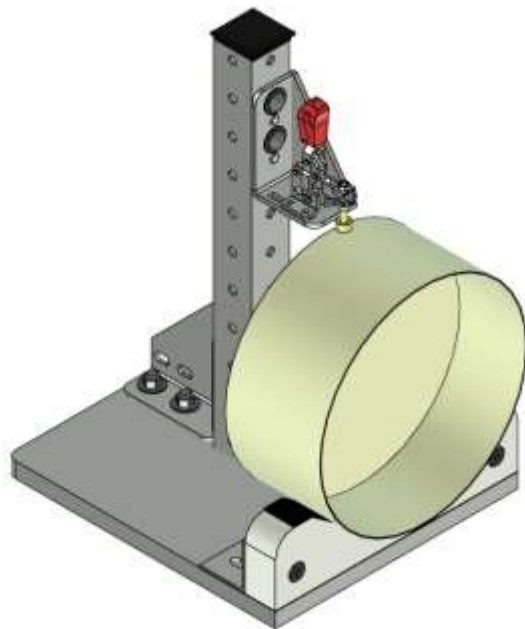

Vol. VII

We Build Lean

Index

| Índice | Indice | Índice | Index

- [4D Fixture](#)
- [4Fasteners](#)

About us

4Lean is a company dedicated to the creation and implementation of Lean solutions. We have a vast knowledge in Lean, we are able to implement a full supply chain with our vast portfolio that is developed in our Lean Lab.

All organization practice Lean everyday. We have regular training in Lean and we participate in Kaizen Events to understand customer needs.

We believe our *gemba* is at customer site, we are a natural extension of your organization.

4Lean é uma empresa dedicada à criação e implementação de soluções Lean. Temos um vasto conhecimento em Lean, somos capazes de implementar uma cadeia de fornecimento completa com o nosso vasto portfólio que é desenvolvido no nosso Laboratório Lean.

Todos na organização praticam Lean diariamente. Temos uma formação regular em Lean e participamos em eventos Kaizen para entender as necessidades dos clientes.

Acreditamos que o nosso *gemba* está à vista do cliente, somos uma extensão natural da sua organização.

4Lean è una società dedicata alla creazione e implementazione di soluzioni di Lean. Abbiamo una vasta conoscenza in Lean e siamo in grado di implementare una catena di approvvigionamento grazie alla nostra vasta gamma sviluppata nel nostro Lean Lab.

Tutta la nostra organizzazione, pratica Lean tutti i giorni. Abbiamo formazione regolare in Lean e partecipiamo a cantieri Kaizen, eventi per capire al meglio i nostri clienti.

Crediamo che il nostro *gemba* è presso il cliente, siamo una naturale estensione della vostra organizzazione.

4Lean es una empresa dedicada a la creación e implementación de soluciones de Lean. Contamos con un amplio conocimiento en Lean, somos capaces de implementar una cadena de suministro completa con nuestro amplio catálogo que se desarrolla en nuestro Laboratorio de Lean.

Todos en la organización practicamos Lean diariamente. Tenemos una formación regular en Lean y participamos en Kaizen Eventos para entender las necesidades del cliente.

Creemos que nuestra *gemba* está en el sitio del cliente, somos una extensión natural de su organización.

4Lean est une société dédiée à la création et la mise en œuvre de solutions Lean. Nous avons une vaste connaissance dans Lean, nous sommes capable de construire une chaîne d'approvisionnement complète avec notre vaste portefeuille qui est développée dans notre Lean Lab.

Tout l'organisation pratique Lean quotidienne. Nous avons régulièrement des formations Lean, nous participons à chantier Kaizen pour comprendre les besoins des clients.

Nous croyons que notre *gemba* est le site du client, nous sommes un prolongement naturel de votre organisation

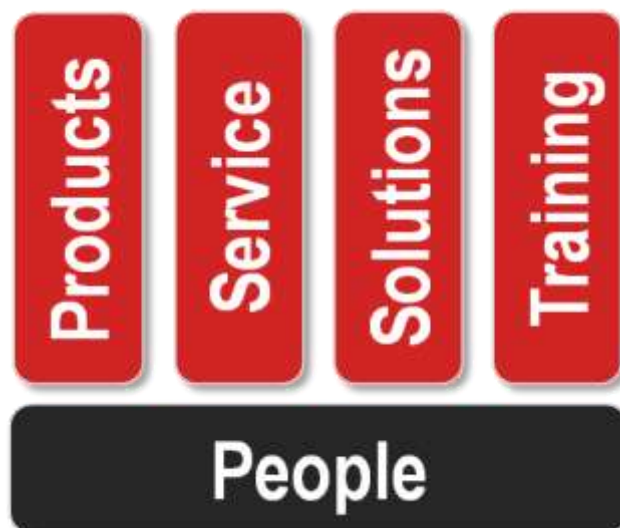

We Build Lean !

Create a fixture

| Crie um gabarito | Crea il dima | Crea la plantilla | Créez le gabarit

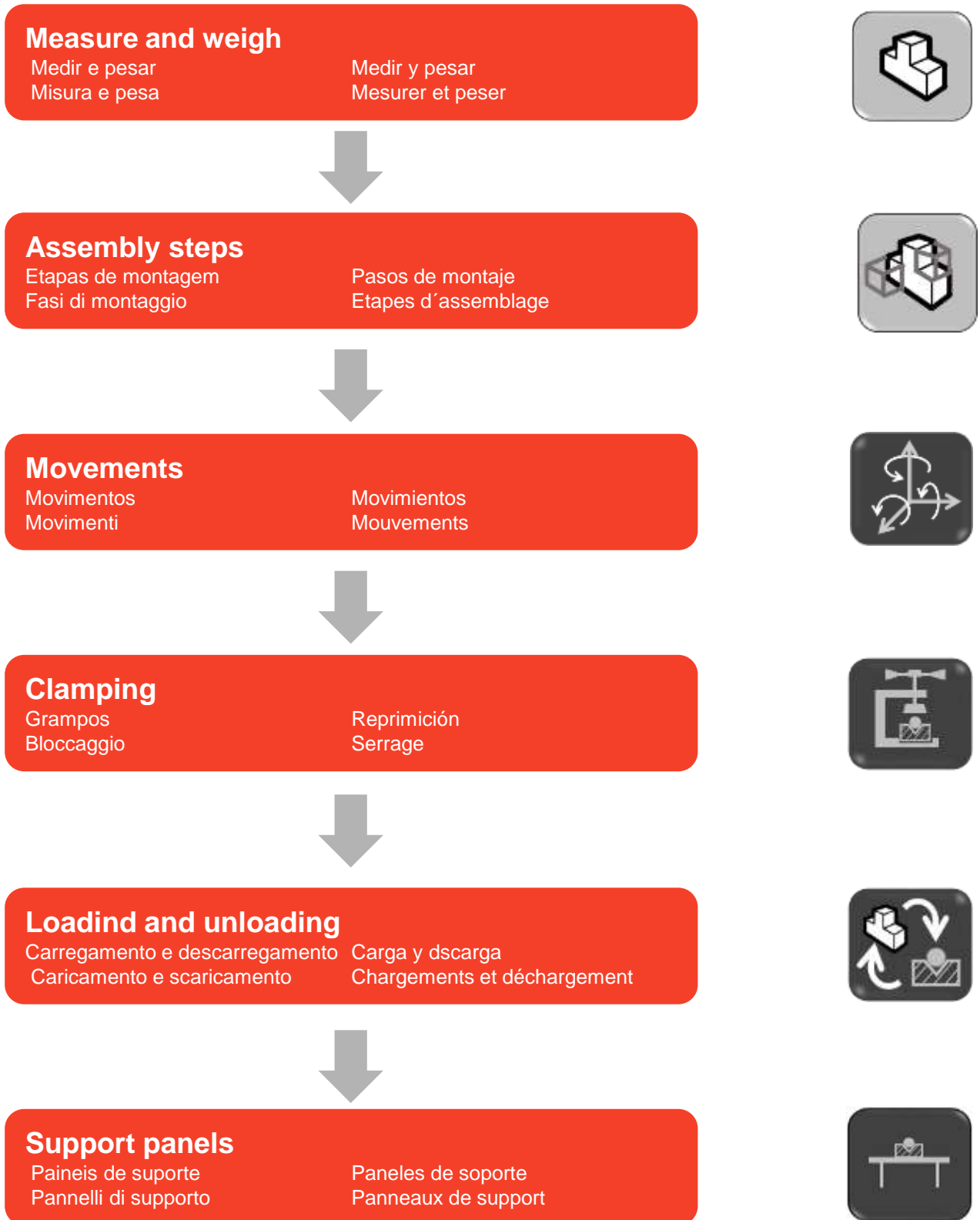

Welding tables

| Mesas de soldadura | Tabelle di saldatura | Mesas de soldadura | Tables de soudage |



Table

| Mesa | Tavoli | Mesas | Les tables |

Reference Referência Articolo Referencia Référence	Product Produto Prodotto Producto Produit	Description Descrição Descrizione Descripción Description	Lenght (mm) Comprimento Lunghezza Longitud Longueur	Width (mm) Largura Larghezza Anchura Largeur
D-2010H		Drilled table	2000	1000
D-2412H			2400	1200
D-OCT800		Octagonal table	800	800
D-OCT1000			1000	1000
D-U1000		U Bar	1000	200
D-U2000			2000	200
D-U4000			4000	200

Feet for table

| Pés para mesa | Piedi per tavolo | Pies por mesa | Pieds pour table |

Reference Referência Articolo Referencia Référence	Product Produto Prodotto Producto Produit	Description Descrição Descrizione Descripción Description	Lenght (mm) Comprimento Lunghezza Longitud Longueur	Tube diameter(mm) Diâmetro do tubo Diámetro del tubo Diámetro del tubo Diamètre du tube
D-620		Rigid foot	680	Ø 89
D-GDT450		Variable height foot	480 – 720	Ø 89
D-JLT620		Foot with swivel caster	680	Ø 89

Brackets & Squares

| Batentes & Esquadros | Staffe e Squadre | Soportes & Cuadrados | Supports & carrés

D-JC175

Dimensions | Dimensioni
Dimensiones | Dimensions

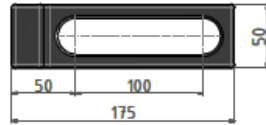

D-JC175HS

Dimensions | Dimensioni
Dimensiones | Dimensions

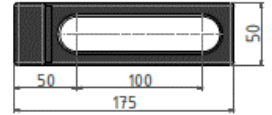

D-ZC300R

Dimensions | Dimensioni
Dimensiones | Dimensions

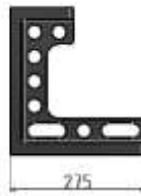

D-ZC300L

Dimensions | Dimensioni
Dimensiones | Dimensions



D-ZC600R

Dimensions | Dimensioni
Dimensiones | Dimensions

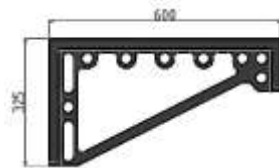

D-ZC600L

Dimensions | Dimensioni
Dimensiones | Dimensions

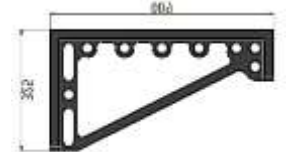

D-ZC800R

Dimensions | Dimensioni
Dimensiones | Dimensions

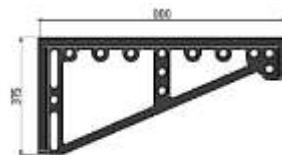

D-ZC800L

Dimensions | Dimensioni
Dimensiones | Dimensions

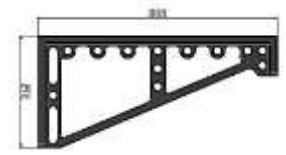

D-JL200

Dimensions | Dimensioni
Dimensiones | Dimensions

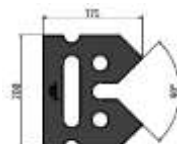

D-JD500

Dimensions | Dimensioni
Dimensiones | Dimensions



Brackets & Squares

| Batentes & Esquadros | Staffe e Squadre | Soportes & Cuadrados | Supports & carrés

D-PC150

Dimensions | Dimensioni
Dimensiones | Dimensions

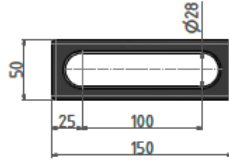

D-PC225

Dimensions | Dimensioni
Dimensiones | Dimensions

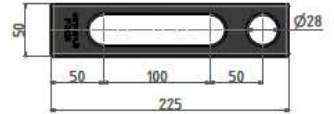

D-PJ175175

Dimensions | Dimensioni
Dimensiones | Dimensions

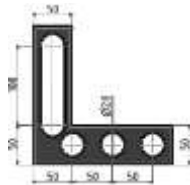

Bolts

| Parafusos | Bullone | Tornillo | Boulon

D-KS2850

Dimensions | Dimensioni
Dimensiones | Dimensions



D-LJ2850

Dimensions | Dimensioni
Dimensiones | Dimensions

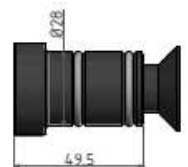

D-JL2825

Dimensions | Dimensioni
Dimensiones | Dimensions



D-CL2825

Dimensions | Dimensioni
Dimensiones | Dimensions



Clamping

| Grampos | Morsetti | Reprimición | Serrage

D-YSS300

Dimensions | Dimensioni
Dimensiones | Dimensions



D-YSQ300

Dimensions | Dimensioni
Dimensiones | Dimensions

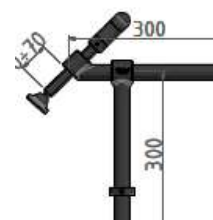

D-YSP300

Dimensions | Dimensioni
Dimensiones | Dimensions



D-JY200C

Dimensions | Dimensioni
Dimensiones | Dimensions



D-YJ200S

Dimensions | Dimensioni
Dimensiones | Dimensions

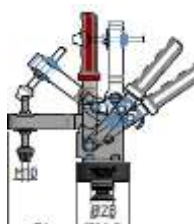

Accessories

| Acessórios | Accessori | Accesorios | Accessoires

CH12-70MR

Weight | Peso | Poids
0,072kg

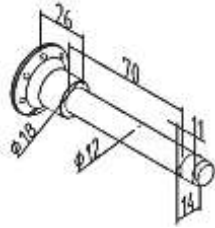

CH8-50MR

Weight | Peso | Poids
0,028kg

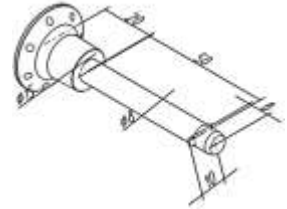

S-CABLE200

Weight | Peso | Poids
0,017kg

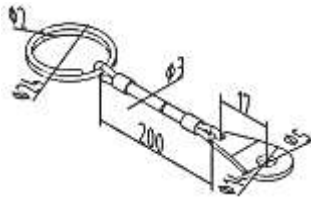

CH8-55MQ

Weight | Peso | Poids
0,040kg

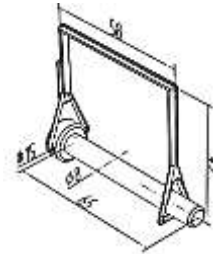
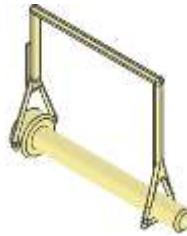

Applications

| Aplicações | Applicazioni | Aplicaciones | Applications

Connection of two tables

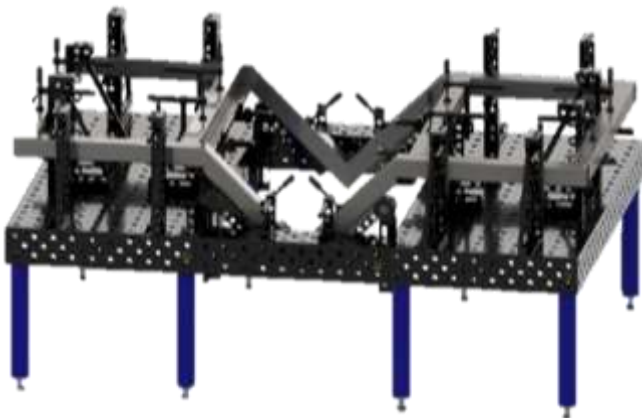

3 axes twelve turnable with octagonal tabeltop



Head & tailstock positioner



Connections with u bar

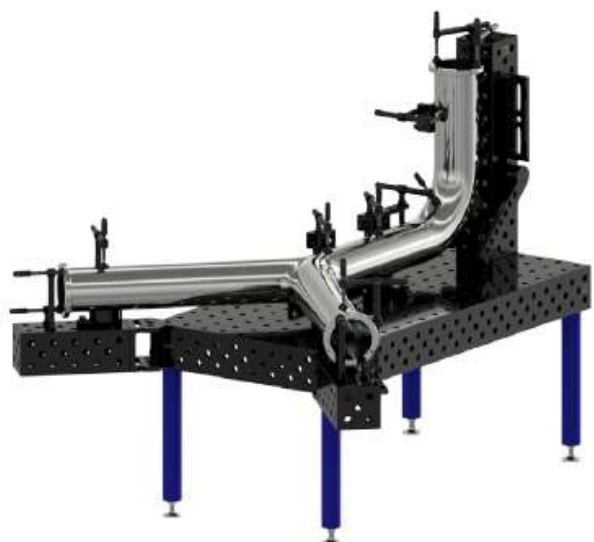

Standing poste

| Posto de trabalho em pé | Poste in piedi | Poste de pie | Poste permanent

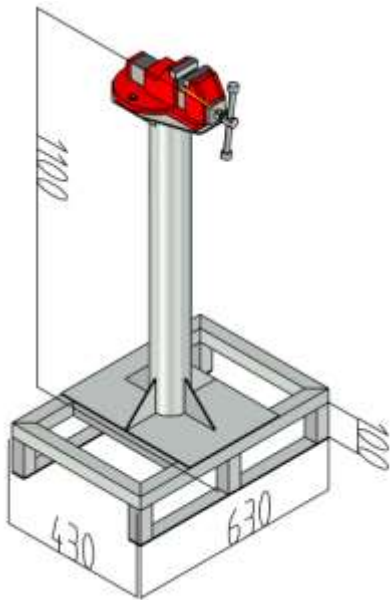

Pallet standing poste

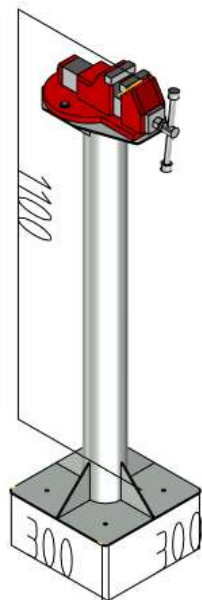



Standing poste

Pallet standing vise	
Reference Referência Articolo Referencia Référence	Product Produto Prodotto Producto Produit
PSP-01	
SP-02	
-	

Fixtures Rotation Cart

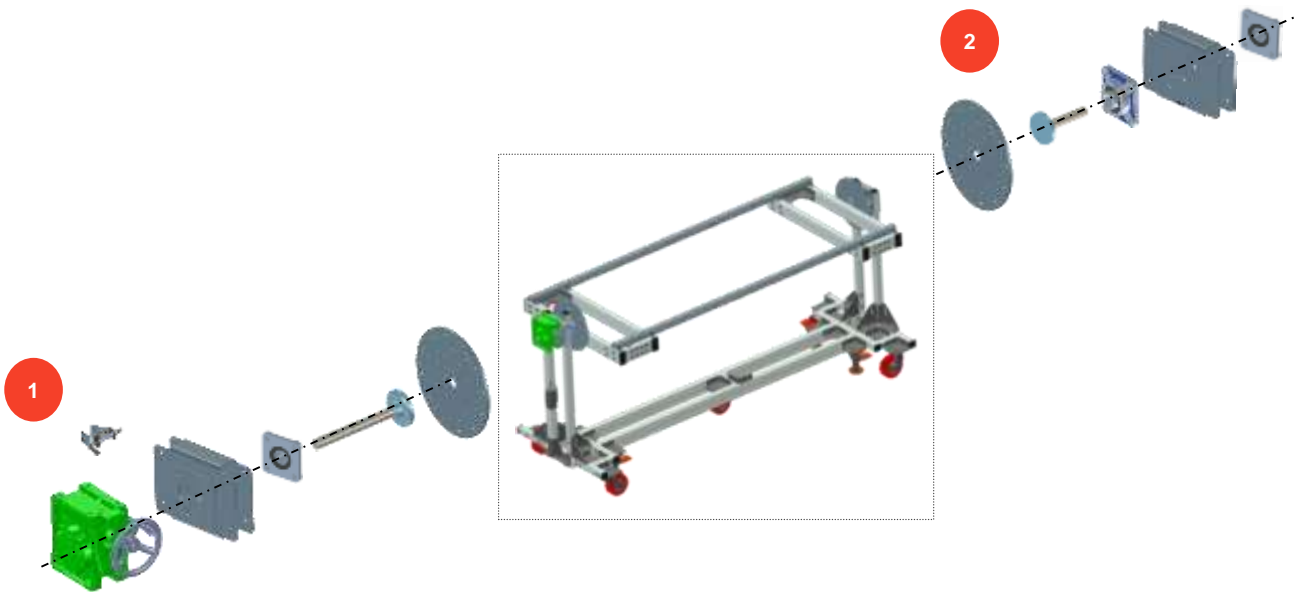
| Carro Gabarit rotativo | Carrello rotazione infissi | Carro Gabarit rotación | Chariot à jauge rotative



Pallet standing vise		
Kit	Reference Referência Articolo Referencia Référence	Product Produto Prodotto Producto Produit
1	R-KW63 *	
2	R-KRAX	

* Max.190N.m

Carts for Rail Guide

| Carros guiados | Carrelli per linea guida | Bogies por línea guía | Chariots à lignes directrices

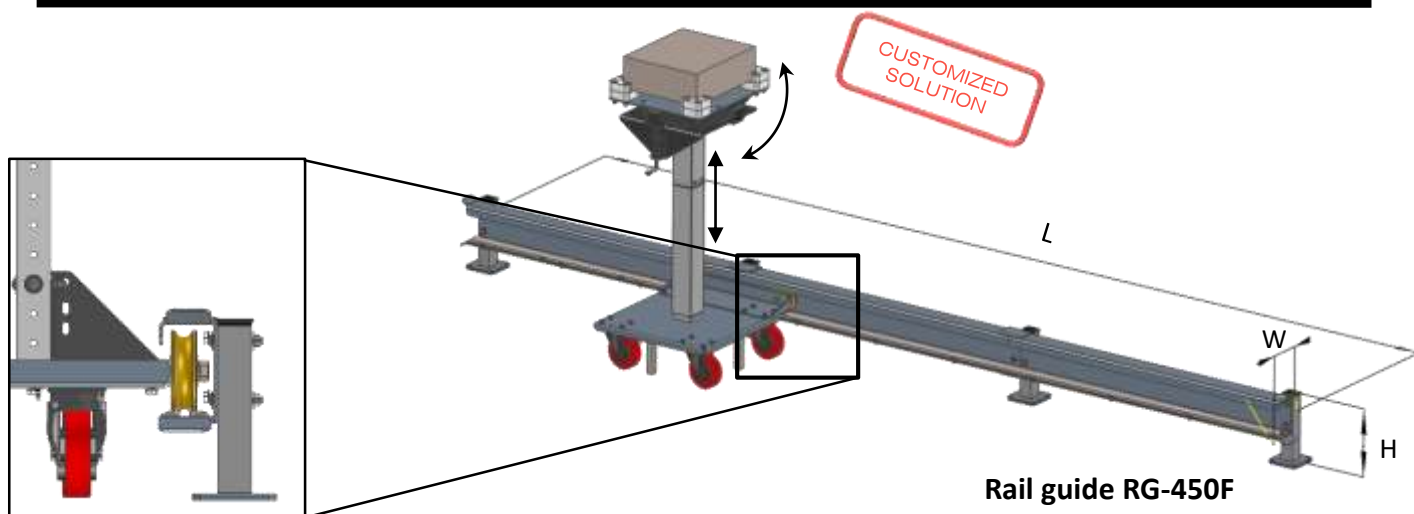

Sheave SH4-450F

Compatible Structures:



Structure Components		
Componentes da estrutura / Componenti della struttura / Componenti della struttura / Composants de structure		
Reference	Description	Dimensions (mm)
SH4-450F	Sheave without support	Ø100
RG-450F	Rail guide for SH4-450F	3000x110x210 (LxWxH)

Stopper for Assembly line

| Batente para linha de montagem | Blocco per linea di montaggio | Bloque para línea de montaje | Bloc pour chaîne de montage

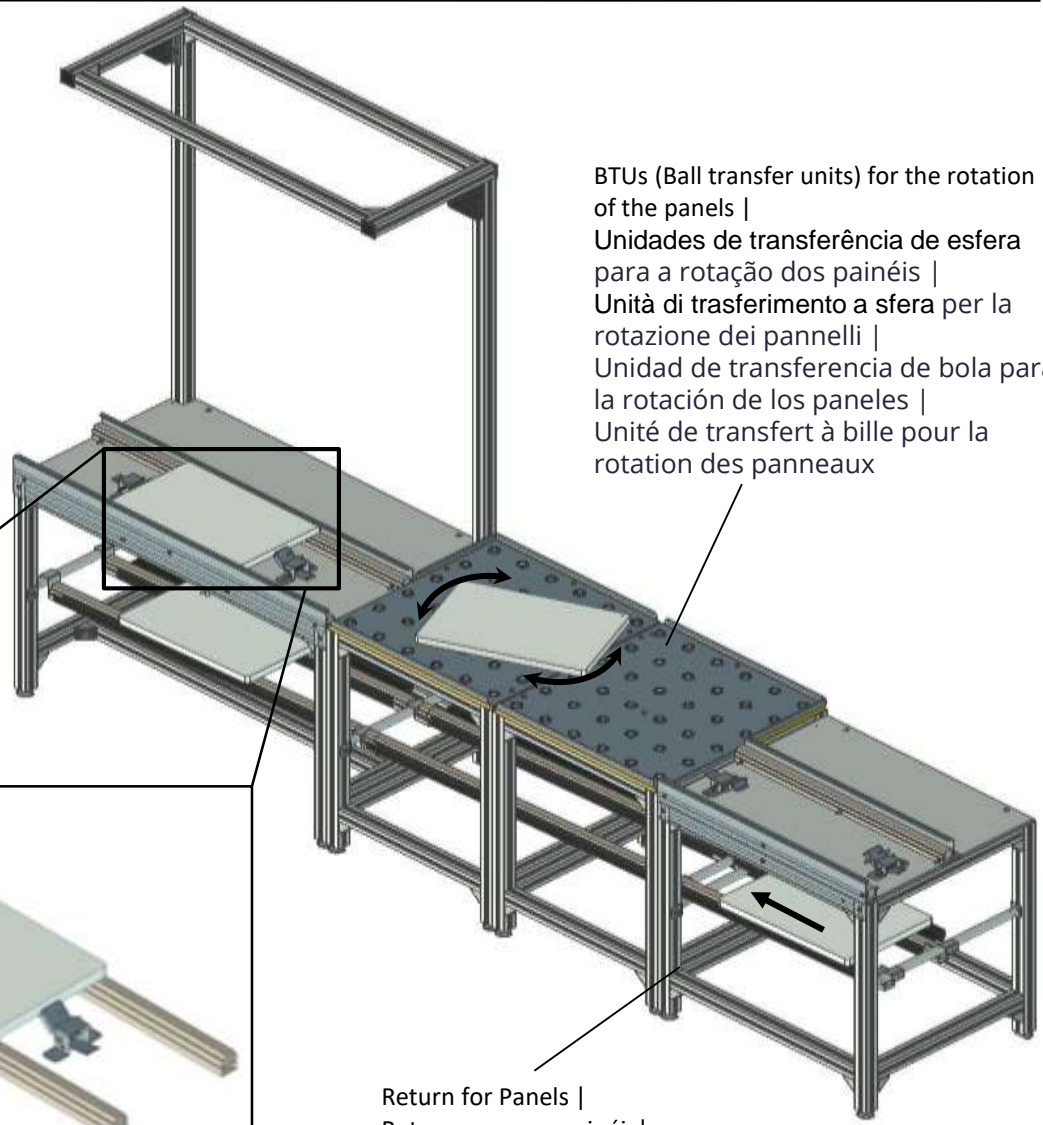

BTUs (Ball transfer units) for the rotation of the panels |
 Unidades de transferência de esfera para a rotação dos painéis |
 Unità di trasferimento a sfera per la rotazione dei pannelli |
 Unidad de transferencia de bola para la rotación de los paneles |
 Unité de transfert à bille pour la rotation des panneaux

Return for Panels |
 Retorno para os painéis |
 Ritorno per i pannelli |
 Retorno para los paneles |
 Retour pour les panneaux

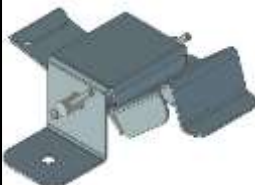

Structure Components		
Componentes da estrutura / Componenti della struttura / Componenti della struttura / Composants de structure		
	Reference	Description
	STOMP	Stopper for panels Batente para os painéis Blocco per i pannelli Bloque para los paneles Bloc pour les panneaux



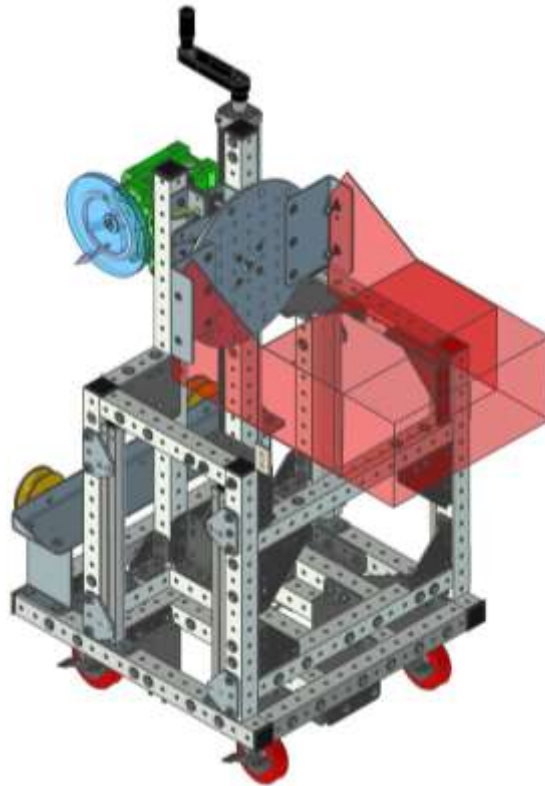

Cart adjustable in height and rotation

| Carro ajustável em altura e rotação | Carrello regolabile in altezza e rotazione | Carro ajustable en altura y rotación | Chariot réglable en hauteur et en rotation

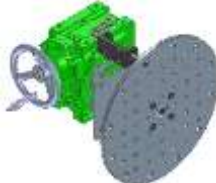
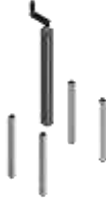

Structure Components

Componentes da estrutura / Componenti della struttura / Componenti della struttura/ Composants de structure

Reference Referência Articolo Referencia Référence	Product Prodotto Prodotto Producto Produit
R-KW63 *	
KC01	
SH4-450F	

* Max.190N.m







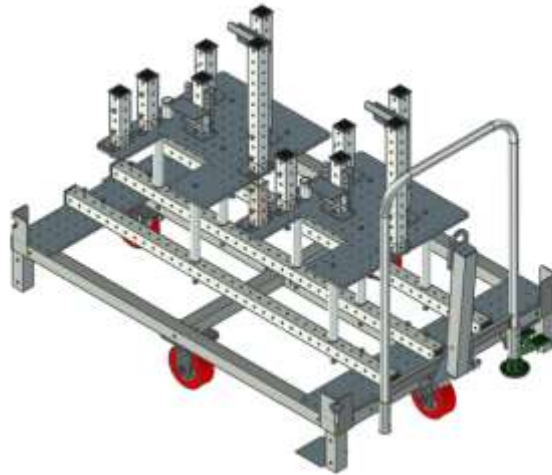

Accessories Fixtures Cart

| Carro Gabarit | Carrello infissi | Carro Gabarit | Chariot à jauge



CUSTOMIZED SOLUTION

Accessories Fixtures Cart	
Reference Referència Articolo Referencia Référence	Product Prodotto Prodotto Producto Produit
J-FC01	
J-FC02	
J-FC03	
J-FC04	
J-FC05	 

Accessories Fixtures Cart

| Carro Gabarit | Carrello infissi | Carro Gabarit | Chariot à jauge

Compatible with:



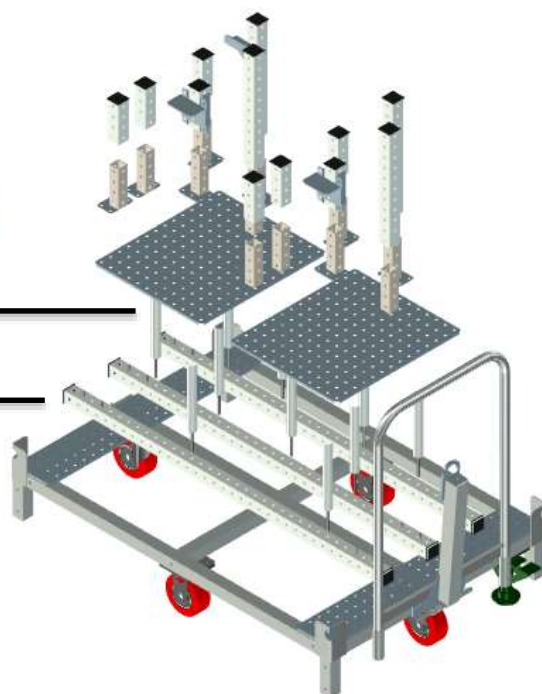

4Lean
System

4Lean
MODULAR



CUSTOMIZED
SOLUTION

Accessories Fixtures Cart

Reference Referência Articolo Referencia Référence	Dimension (mm) Dimensão (mm) Dimensione (mm) Dimensión (mm) Dimension (mm)	Product Produto Prodotto Producto Produit
J-CFB01	1230*830	
J-CFB02	1430*1200	
J-FC01	-	
J-CH01	485*415	

4fastening

4fastening

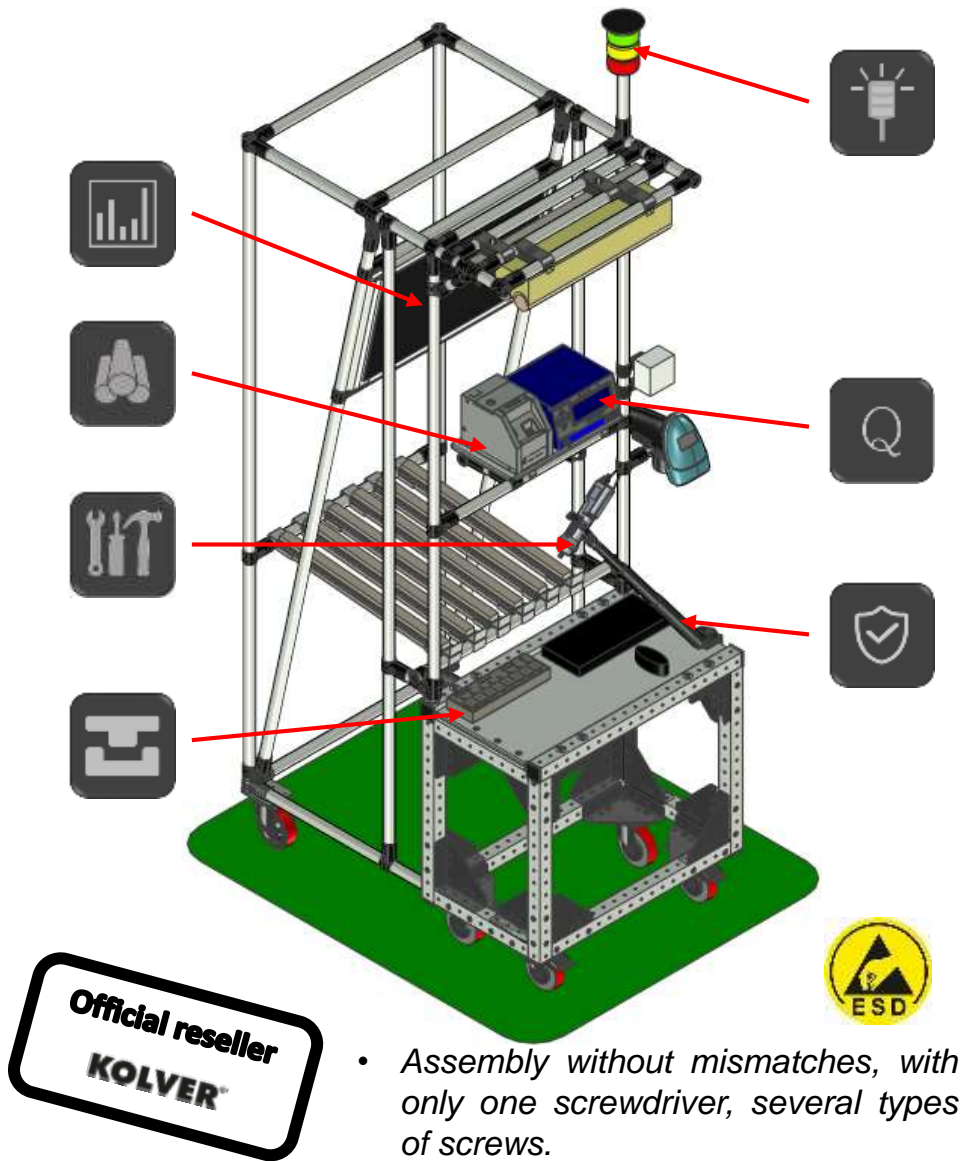

Screwdriver 4.0



Quality

- Rotation with torque control.
- Angle control.
- Acceleration ramp control.
- Screw count function.
- Min/Max screwing time control.
- Auto reverse.
- Program selection with barcode.
- Sequence of programs with auto switch.
- Positioning system control.



Statistics and Programming

- Control statistics.
- Remote programming.



Safety

- Eliminates the reaction generated by the screwdrivers when stop it.
- Ergonomic design.



Tool

- Torque range 0,5 - 70 Nm



Andon

- LED Status Indicators (ok, error, tightening, etc.)



SMED

- *Socket tray*, automatically selects the preset program when a bit or socket is removed.



RAW Material

- *Feeder* reduces picking time.



ESD

- All components have ESD protection

Screwdriver 4.0



KSB

0.05 – 70 Nm



Quality

- Rotation with torque control.
- Angle control.
- Acceleration ramp control.
- Screw count function.
- Min/Max screwing time control.
- Auto reverse..



Nato & Mito

0.02 – 1.5 Nm



Pluto

0.5-70 Nm



Safety

- Ergonomic design.



FAB & RAF

0.05 – 5 Nm



ESD

- All components have ESD protection



KBL

0.04 – 4 Nm

Torque Analyser Software



Statistics and Programming

- Control statistics.
- Remote programming.

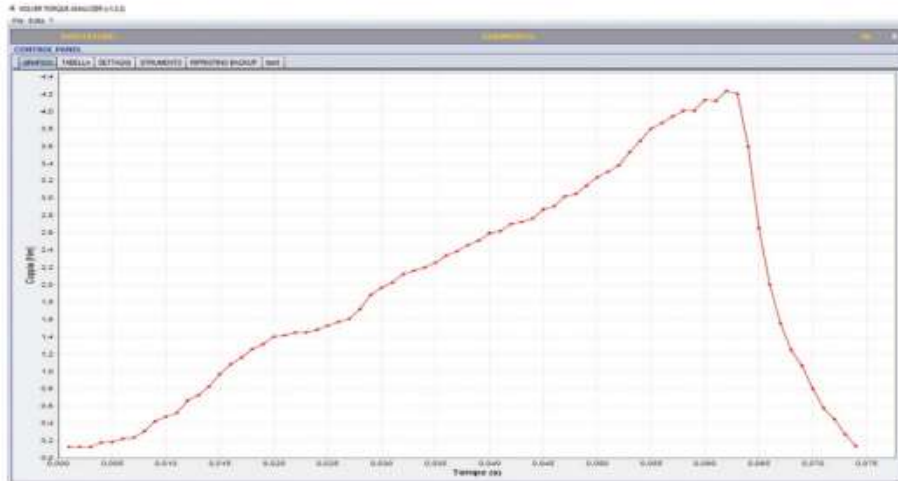

4 KOLVER TORQUE ANALYSER v1.0.0
File Edit View

CONTROL PANEL

NO.	TORQUE (NM)	HCUR	DATE	SOFTWARE
1	2.518	14/11/2018	10/11/2018	PLUTO 100/TA
2	2.544	14/11/2018	10/11/2018	PLUTO 100/TA
3	2.502	14/11/2018	10/11/2018	PLUTO 100/TA
4	2.577	14/11/2018	10/11/2018	PLUTO 100/TA
5	2.565	14/11/2018	10/11/2018	PLUTO 100/TA
6	2.532	14/11/2018	10/11/2018	PLUTO 100/TA
7	2.536	14/11/2018	10/11/2018	PLUTO 100/TA
8	2.514	14/11/2018	10/11/2018	PLUTO 100/TA
9	2.511	14/11/2018	10/11/2018	PLUTO 100/TA
10	2.548	14/11/2018	10/11/2018	PLUTO 100/TA
11	2.574	14/11/2018	10/11/2018	PLUTO 100/TA
12	2.588	14/11/2018	10/11/2018	PLUTO 100/TA
13	2.558	14/11/2018	10/11/2018	PLUTO 100/TA
14	2.562	14/11/2018	10/11/2018	PLUTO 100/TA
15	2.525	14/11/2018	10/11/2018	PLUTO 100/TA
16	2.565	14/11/2018	10/11/2018	PLUTO 100/TA
17	2.582	14/11/2018	10/11/2018	PLUTO 100/TA
18	2.502	14/11/2018	10/11/2018	PLUTO 100/TA
19	2.505	14/11/2018	10/11/2018	PLUTO 100/TA
20	2.518	14/11/2018	10/11/2018	PLUTO 100/TA
21	2.515	14/11/2018	10/11/2018	PLUTO 100/TA
22	2.588	14/11/2018	10/11/2018	PLUTO 100/TA
23	2.585	14/11/2018	10/11/2018	PLUTO 100/TA
24	2.543	14/11/2018	10/11/2018	PLUTO 100/TA
25	2.539	14/11/2018	10/11/2018	PLUTO 100/TA
26	2.595	14/11/2018	10/11/2018	PLUTO 100/TA
27	2.585	14/11/2018	10/11/2018	PLUTO 100/TA
28	2.508	14/11/2018	10/11/2018	PLUTO 100/TA
29	2.588	14/11/2018	10/11/2018	PLUTO 100/TA

SPECIAL INFO

TRACK

TEST

REPORT

HELP

TOTAL STATISTICAL VALUES

Minimum value: 2.502
Maximum value: 2.588
Average: 2.557
Max. capacity: 0.07500 (1.33)
Cut-off: 2.6000
Peak value: 2.5882
Name: 0.0000

FIXING SPECIFICATION

Minimum torque: 1.8000
Maximum torque: 2.8000
Maximum torque: 2.8000
Tolerance: 10
Precision: 0.0000

SHOW VALUE

2.528

ACTUAL VALUE

MAX: 2.528
MIN: NULL
AVERAGE: NULL

KOLVER

Torque Reaction Arms



Safety

- Eliminates the reaction generated by the screwdrivers when stop it.

Support arm models



PA2KOL Folding Arm



P57KOL Folding Arm



LINAR and LINART Arms



CAR Telescopic Carbon Arm



SAR XYZ Suspended Arm



SAR XZ



SAR Z

Positioning Arms



Quality

- Positioning system control.

Positioning arm models



TLS1/CAR Positioning Carbon Arm



TLS1/LINAR1 and TLS1/LINAR2



TLS1/LINART Positioning Folding Arm



TLS1/SAR XYZ Suspended Arm

Screw Feeders



RAW Material

- Feeder reduces picking time.



Up to M5

Keyboards



Quality

- Program selection with barcode.
- Sequence of programs with auto switch..



SMED

- *Socket tray*, automatically selects the preset program when a bit or socket is removed.



VOLUME C **EASYARM**

PREVENT THE PROBLEM WITH

MOST COMMON TYPE OF INJURIES

- CUTS AND WOUNDS
- SPRAINS AND STRAINS
- FRACTURES

MOST COMMON CAUSES OF INJURIES

- OVERWEARINESS
- REPETITIVE ACTIONS
- BUMP, CUT OR CAUGHT BY EQUIPMENT

WORKER SAFETY

- ELIMINATE THE MOST COMMON CAUSES OF WORKER INJURIES
- WORKER CAN BE MORE PRODUCTIVE WITH LESS STRAIN
- THE WEIGHT LOAD IS TAKEN OFF THE WORKER
- MAINTAINING SAFETY DISTANCES FOR WORKERS LIMBS
- CARRY THE TOOL IN TIGHT SPACES WHILE KEEPING WORKERS SAFE
- CUTS THE LARGE COSTS OF WORKER INJURIES

SHOULDERS

BACK

HANDS

KNEES

ANKLES

EASYARM SOLUTION FOR YOUR WORKS

Volumec® constantly develops new articulated arm solutions to improve ergonomics, reduce efforts and improve work performance by increasing safety.

The new *Easyarm Evo2* product line is characterized by a special aluminum profile designed to give each articulated arm maximum fluidity in movement, creating an effect of *zero gravity* but guaranteeing rigidity when required.

The joints are all integrated into the articulated arm, every single element that composes it is studied in detail and created with CNC machines with high quality standards.

Easyarm offers a complete line of heads for fixing tools or devices that can be selected according to the type of machining to be performed.

The new line of *revolving* orbital attachments offers maximum versatility of choice with the advantage of being able to position the tool both upwards and downwards according to the work area to be reached.

YOUR REQUIREMENT? PROVIDE THE DATA:





TOOLS TYPE:
MODEL :
APPLICATIONS :
WORK DIRECTIONS:
WEIGHT:
TOOL DRAWING 3D STEP



Ergonomic arms

SERIES EA 1/EAB 1

A single balanced arm for the most basic and repetitive applications, it can be fixed both to the bench and to the ceiling.

REACH	VERTICAL STROKE	ROTATION	ARM WEIGHT
			
810 mm	755 mm	360°	11-13 Kg
32 in	30 in		24-28 lbs

COMPATIBLE HEAD

ALL

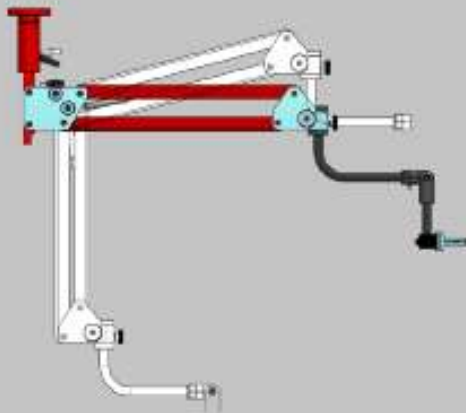

WEIGHT RANGE 1-19 Kg
2-42 LBS



ARTICULATED ARM EA1

MODEL	MAX TORQUE	WEIGHT BALANCED
EA085003	150 Nm	1,5 - 3 Kg
EA085006	150 Nm	3,5 - 6 Kg
EA085010	150 Nm	6,5 - 10 Kg
EA086015	200 Nm	11 - 14 Kg
EA086019	200 Nm	15 - 19 Kg

ARTICULATED ARM WITH LOCKING SYSTEM EAB 1

The EAB series can be used as standard balanced arm with the option of lock the tool to a desired height and maintained over the entire work area.

MODEL	MAX TORQUE	WEIGHT BALANCED
EAB086003	200 Nm	1,5 - 3 Kg
EAB086006	200 Nm	3,5 - 6 Kg
EAB086010	200 Nm	6,5 - 10 Kg
EAB086015	200 Nm	11 - 14 Kg
EAB086020	200 Nm	15 - 19 Kg

ORBITAL ATTACHMENT B2



ORBITAL ATTACHMENT A4



ORBITAL ATTACHMENT A3-T60







EA1
HEAD A3 - T40



SERIES EA2/EAB2

The articulated arm EA2 balances the weight of the tool or equipment in all working area, guaranteeing fast and precise movements without effort. ZERO GRAVITY.

REACH	VERTICAL STROKE	ROTATION	ARM WEIGHT
			
1270 mm	755 mm	360°	15-25 kg
71 in	57 in		33-55 lbs

COMPATIBLE HEAD

ALL

* EAT (only fix head)

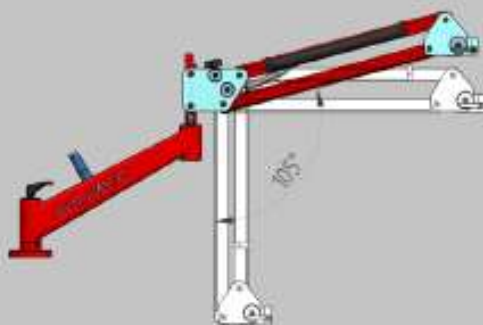

WEIGHT RANGE 1-25 KG
2-55 LBS

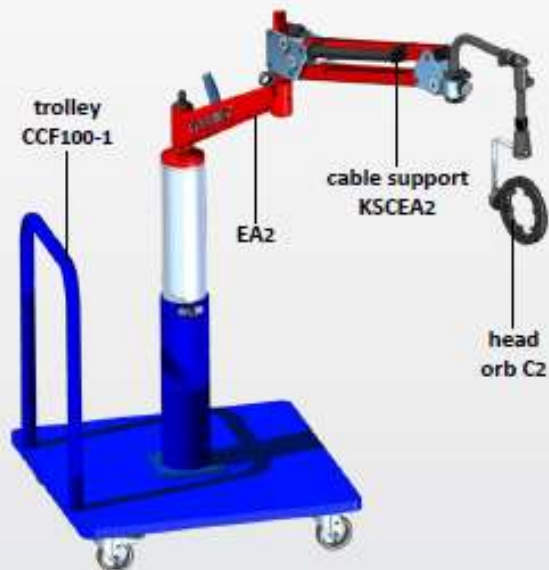

STANDARD DOUBLE ARTICULATED ARM EA2

MODEL	MAX TORQUE	WEIGHT BALANCED
EA135003	150 Nm	1,5 - 3 kg
EA135006	150 Nm	3,5 - 6 kg
EA136010	200 Nm	6,5 - 10 kg
EA136015	200 Nm	11 - 14 kg
EA136019	200 Nm	15 - 19 kg
EAT138030*	300 Nm	20 - 25 kg

DOUBLE ARTICULATED ARM WITH LOCKING SYSTEM EAB2

The EAB2 series has the same advantages as the EA2 with the option to lock the vertical stroke to a desired height and maintained over the entire work area.

MODEL	MAX TORQUE	WEIGHT BALANCED
EAB136003	200 Nm	1,5 - 3 kg
EAB136006	200 Nm	3,5 - 6 kg
EAB136010	200 Nm	6,5 - 10 kg
EAB136015	200 Nm	11 - 14 kg
EAB136020	200 Nm	15 - 18 kg

ORBITAL ATTACHMENT E



M +T60+A60



ORBITAL ATTACHMENT B3



EA2 - HEAD C2
TROLLEY CCF100-1





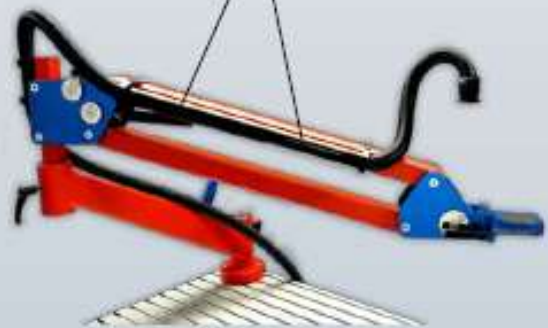

wiring
support



SERIES EA3/EAB3

The EA3 series is a triple articulated arm with double independent balancing system, its pantograph structure is resistant to efforts with maximum fluidity and precision in movements.

With its large working area and vertical stroke it is the most widespread of the Easyarm series

REACH	VERTICAL STROKE	ROTATION	ARM WEIGHT
			
1950 mm	1305 mm	360°	19-22 Kg
77 in	51 in		42-48 lbs

COMPATIBLE HEAD

ALL

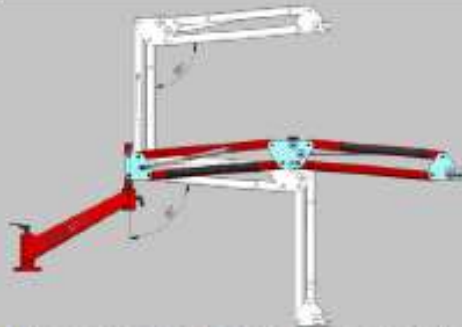

STANDARD TRIPLE ARTICULATED ARM EA3

MODEL	MAX TORQUE	WEIGHT BALANCED
EA195002	150 Nm	1,3 - 2,5 Kg
EA195004	150 Nm	2,5 - 5 Kg
EA195010	180 Nm	5,3 - 8 Kg
EA196010	250 Nm	8,3 - 11 Kg
EA196015	250 Nm	11,3 - 15 Kg
EA196020	250 Nm	16 - 20 kg
EA196025	250 Nm	21 - 25 kg

TRIPLE ARTICULATED ARM WITH LOCKING SYSTEM EAB3

The EAB3 series has the same advantages as the EA3 with the option of lock the vertical stroke to a desired height and maintained over the entire work area.

MODEL	MAX TORQUE	WEIGHT BALANCED
EAB196002	150 Nm	1,3 - 2 Kg
EAB196004	150 Nm	2,5 - 5 Kg
EAB196008	250 Nm	5,3 - 8 Kg
EAB196010	250 Nm	8,3 - 11 Kg
EAB196015	250 Nm	11,3 - 15 Kg

WEIGHT RANGE 1-25 KG
2-55 LBS

BENCH FIXING (standard)	CEILING FIXING (S) version
	no

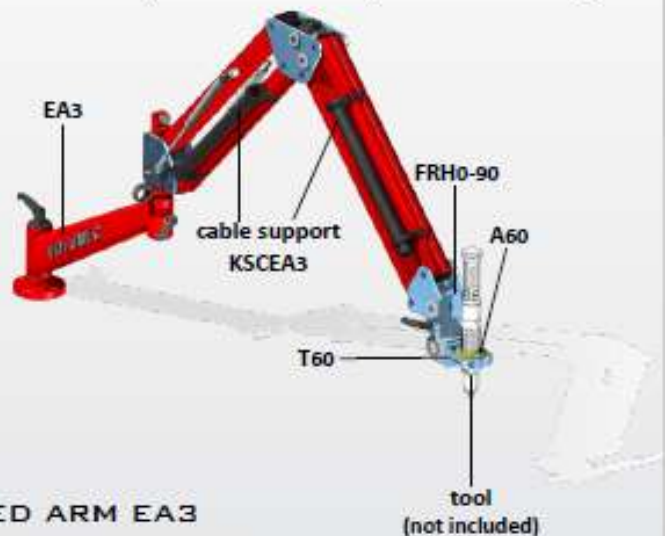

ORBITAL CUSTOM



MULTIDIRECTIONAL HEAD



HEAD F1







EA3 - HEAD C2
TROLLEY CCF100-1



SERIES EA4/EAB4

the EA4 series has the highest freedom of movement which makes it ideal even for the most difficult to reach processes, its conformation allows it to operate both upwards and downwards with maximum fluidity in all directions

REACH	VERTICAL STROKE	ROTATION	ARM WEIGHT
			
1800 mm	1450 mm	360 °	20-22 Kg
72 in	57 in		42-48 lbs

COMPATIBLE HEAD

ALL

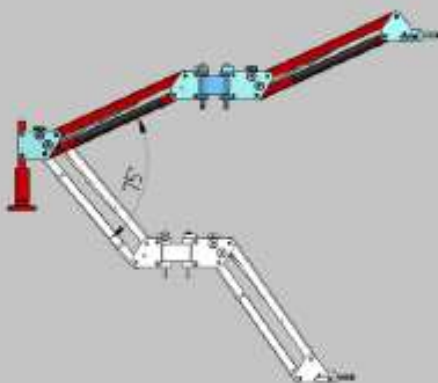

WEIGHT RANGE 1-10 KG
2-22 LBS

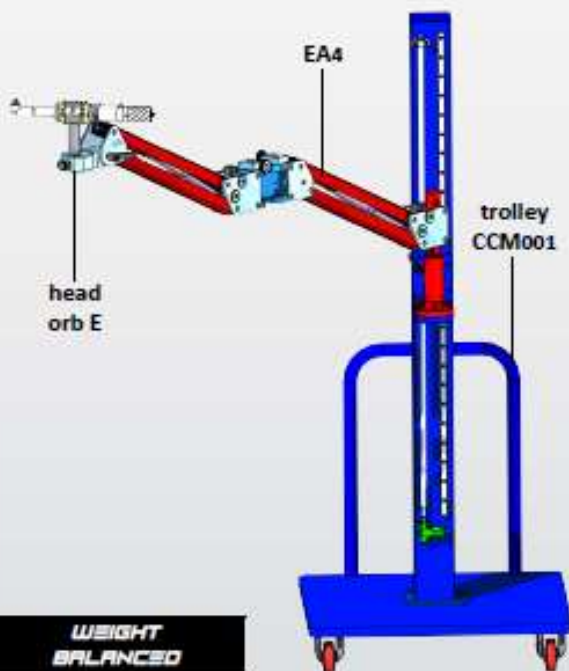
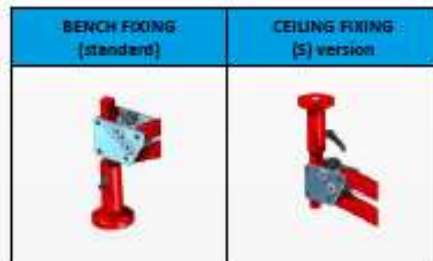

MULTI ARTICULATED ARM EA4

MODEL	MAX TORQUE	WEIGHT BALANCED
EA186002	200 Nm	1,5 - 2 kg
EA186004	200 Nm	2,5 - 5 kg
EA186008	200 Nm	3,5 - 8 kg
EA186010	200 Nm	8,5 - 10 kg

MULTI ARTICULATED ARM WITH LOCKING SYSTEM EAB4

The EAB4 series has the same advantages as the EA4 with the option of lock the vertical stroke to a desired height and maintained over the entire work area.

MODEL	MAX TORQUE	WEIGHT BALANCED
EAB186002	200 Nm	1,5 - 2 kg
EAB186004	200 Nm	2,5 - 5 kg
EAB186008	200 Nm	3,5 - 8 kg
EAB186010	200 Nm	8,5 - 10 kg

EA4-HEAD D2

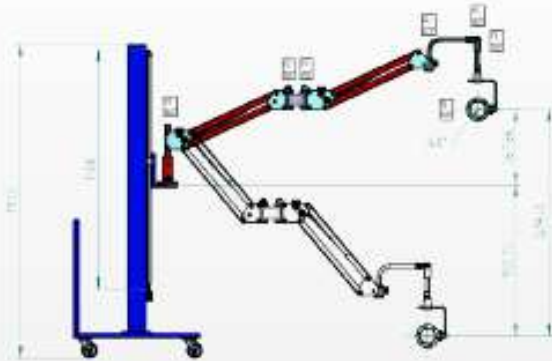

EA4-HEAD E



EA4-HEAD D2-TROLLEY CCM001

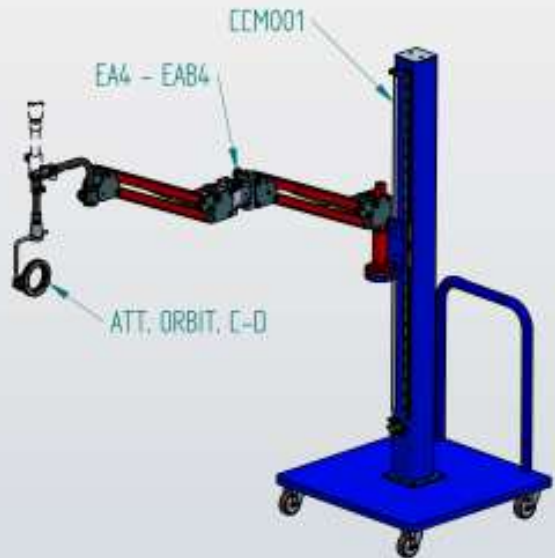





EAT3



Ergonomic arms

SERIES EAT3

The EAT3 triple articulated arm allows you to balance heavy tools and block high working torque.

REACH	VERTICAL STROKE	ROTATION	ARM WEIGHT
			
1650 mm	900 mm	360°	62 kg
65 in	35 in		137 lbs

COMPATIBLE HEAD

ALL EAT SERIES SUPPLY WITH FIX HEAD INCLUDED

8-40 KG
18-88 LBS

BENCH FIXING (standard)	CEILING FIXING (S) version
	no

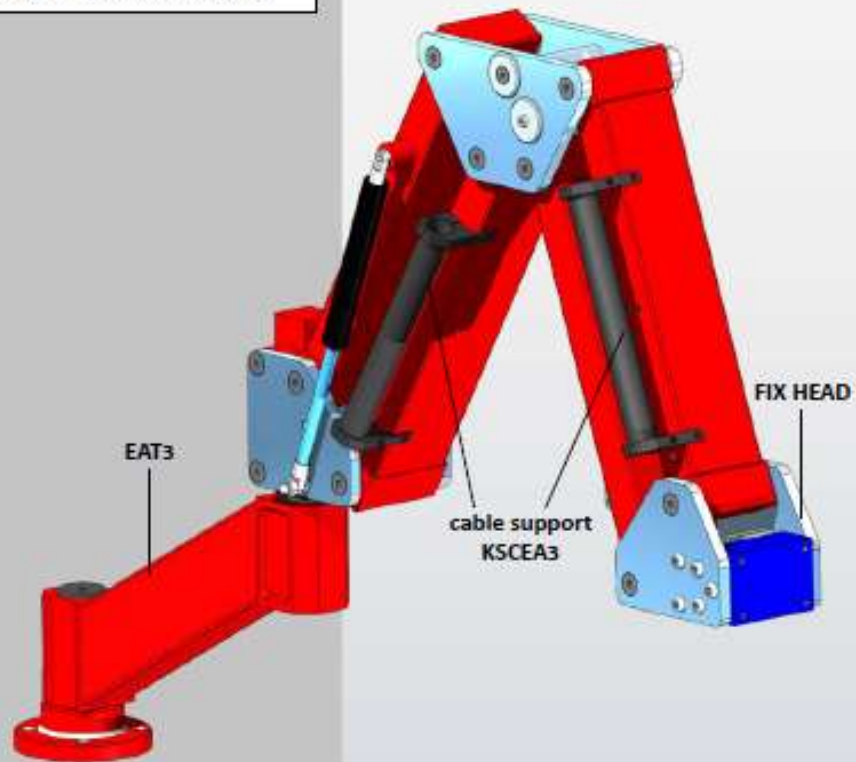







TRIPLE ARTICULATED ARTICULATED ARM EAT3

MODEL	MAX TORQUE	WEIGHT BALANCED
EAT1610014	500 Nm	8 - 14 kg
EAT1610019	500 Nm	15 - 19 kg
EAT1610025	500 Nm	20 - 25 kg
EAT1610030	500 Nm	26 - 30 kg
EAT1610035	500 Nm	31 - 35 kg
EAT1610040	500 Nm	36 - 40 kg

TOOL HEAD













<p>M - Multi-directional head adjustable and lockable in different angles:</p> <table border="1" data-bbox="238 353 555 466"> <tr> <td>COMPATIBLE WITH: Max 8 Kg</td> <td>EA2/EAB2 EA3/EAB3 EA4/EAB4</td> </tr> </table>  <p>M1 - Multi-directional head adjustable and lockable in different angles:</p> <table border="1" data-bbox="238 568 555 680"> <tr> <td>COMPATIBLE WITH: Max 14 Kg</td> <td>EA2/EAB2 EA3/EAB3 EA4/EAB4</td> </tr> </table>	COMPATIBLE WITH: Max 8 Kg	EA2/EAB2 EA3/EAB3 EA4/EAB4	COMPATIBLE WITH: Max 14 Kg	EA2/EAB2 EA3/EAB3 EA4/EAB4	<p>FRH0-90 Rapid positioning head 0°-90° EXCLUDED CLAMP FOR TOOL ATTACHMENT (T)</p> <table border="1" data-bbox="792 353 1170 466"> <tr> <td>COMPATIBLE WITH: Max 8 Kg</td> <td>EA2/EAB2 EA3/EAB3 EA4/EAB4</td> </tr> </table> 	COMPATIBLE WITH: Max 8 Kg	EA2/EAB2 EA3/EAB3 EA4/EAB4
COMPATIBLE WITH: Max 8 Kg	EA2/EAB2 EA3/EAB3 EA4/EAB4						
COMPATIBLE WITH: Max 14 Kg	EA2/EAB2 EA3/EAB3 EA4/EAB4						
COMPATIBLE WITH: Max 8 Kg	EA2/EAB2 EA3/EAB3 EA4/EAB4						
<p>T40 - T60 - T80 Clamp for tool attachment diameter 40 - 60 - 80 mm</p> <table border="1" data-bbox="238 788 555 901"> <tr> <td>COMPATIBLE WITH:</td> <td>M FRH0-90 A2-A3</td> </tr> </table> 	COMPATIBLE WITH:	M FRH0-90 A2-A3	<p>A40 - A60 - A80 Adapter for 40-60-80 mm smaller diameter</p> 				
COMPATIBLE WITH:	M FRH0-90 A2-A3						

ORBITAL ATTACHMENTS

<p>A1 ORBITAL ATTACHMENT</p>  <table border="1" data-bbox="238 1191 555 1304"> <tr> <td>COMPATIBLE WITH:</td> <td>EA1/EAB1 EA2/EAB2 EA3/EAB3 EA4/EAB4</td> </tr> </table>	COMPATIBLE WITH:	EA1/EAB1 EA2/EAB2 EA3/EAB3 EA4/EAB4	<p>A2 ORBITAL ATTACHMENT EXCLUDED CLAMP FOR TOOL ATTACHMENT (T)</p>  <table border="1" data-bbox="792 1191 1170 1304"> <tr> <td>COMPATIBLE WITH:</td> <td>EA1/EAB1 EA2/EAB2 EA3/EAB3 EA4/EAB4</td> </tr> </table>	COMPATIBLE WITH:	EA1/EAB1 EA2/EAB2 EA3/EAB3 EA4/EAB4
COMPATIBLE WITH:	EA1/EAB1 EA2/EAB2 EA3/EAB3 EA4/EAB4				
COMPATIBLE WITH:	EA1/EAB1 EA2/EAB2 EA3/EAB3 EA4/EAB4				
<p>A3 ORBITAL ATTACHMENT EXCLUDED CLAMP FOR TOOL ATTACHMENT (T)</p>  <table border="1" data-bbox="238 1463 555 1575"> <tr> <td>COMPATIBLE WITH:</td> <td>EA1/EAB1 EA2/EAB2 EA3/EAB3 EA4/EAB4</td> </tr> </table>	COMPATIBLE WITH:	EA1/EAB1 EA2/EAB2 EA3/EAB3 EA4/EAB4	<p>A4 ORBITAL ATTACHMENT</p>  <table border="1" data-bbox="792 1463 1099 1575"> <tr> <td>COMPATIBLE WITH:</td> <td>EA1/EAB1 EA2/EAB2 EA3/EAB3 EA4/EAB4</td> </tr> </table>	COMPATIBLE WITH:	EA1/EAB1 EA2/EAB2 EA3/EAB3 EA4/EAB4
COMPATIBLE WITH:	EA1/EAB1 EA2/EAB2 EA3/EAB3 EA4/EAB4				
COMPATIBLE WITH:	EA1/EAB1 EA2/EAB2 EA3/EAB3 EA4/EAB4				
<p>B1 ORBITAL ATTACHMENT</p>  <table border="1" data-bbox="238 1712 555 1825"> <tr> <td>COMPATIBLE WITH:</td> <td>EA1/EAB1 EA2/EAB2 EA3/EAB3 EA4/EAB4</td> </tr> </table>	COMPATIBLE WITH:	EA1/EAB1 EA2/EAB2 EA3/EAB3 EA4/EAB4	<p>B2 ORBITAL ATTACHMENT</p>  <table border="1" data-bbox="792 1739 1099 1825"> <tr> <td>COMPATIBLE WITH:</td> <td>EA1/EAB1 EA2/EAB2 EA3/EAB3</td> </tr> </table>	COMPATIBLE WITH:	EA1/EAB1 EA2/EAB2 EA3/EAB3
COMPATIBLE WITH:	EA1/EAB1 EA2/EAB2 EA3/EAB3 EA4/EAB4				
COMPATIBLE WITH:	EA1/EAB1 EA2/EAB2 EA3/EAB3				

<p>B3 ORBITAL ATTACHMENT CLAMPS FOR TOOL ATTACHEMENT EXCLUDED</p>  <table border="1" data-bbox="244 429 556 521"> <tr> <td>COMPATIBLE WITH:</td> <td>EA1/EAB1 EA2/EAB2 EA3/EAB3</td> </tr> </table>	COMPATIBLE WITH:	EA1/EAB1 EA2/EAB2 EA3/EAB3	<p>C1 ORBITAL ATTACHMENT MAXIMUM TOOL DIAMETER 125 mm</p>  <table border="1" data-bbox="793 408 1164 521"> <tr> <td>COMPATIBLE WITH:</td> <td>EA1/EAB1 EA2/EAB2 EA3/EAB3 EA4/EAB4</td> </tr> </table>	COMPATIBLE WITH:	EA1/EAB1 EA2/EAB2 EA3/EAB3 EA4/EAB4		
COMPATIBLE WITH:	EA1/EAB1 EA2/EAB2 EA3/EAB3						
COMPATIBLE WITH:	EA1/EAB1 EA2/EAB2 EA3/EAB3 EA4/EAB4						
<p>C2 ORBITAL ATTACHMENT MAXIMUM TOOL DIAMETER 125 mm</p>  <table border="1" data-bbox="244 725 556 838"> <tr> <td>COMPATIBLE WITH:</td> <td>EA1/EAB1 EA2/EAB2 EA3/EAB3 EA4/EAB4</td> </tr> </table>	COMPATIBLE WITH:	EA1/EAB1 EA2/EAB2 EA3/EAB3 EA4/EAB4	<p>D1 ORBITAL ATTACHMENT MAXIMUM TOOL DIAMETER 85 mm</p>  <table border="1" data-bbox="793 725 1105 838"> <tr> <td>COMPATIBLE WITH:</td> <td>EA1/EAB1 EA2/EAB2 EA3/EAB3 EA4/EAB4</td> </tr> </table>	COMPATIBLE WITH:	EA1/EAB1 EA2/EAB2 EA3/EAB3 EA4/EAB4		
COMPATIBLE WITH:	EA1/EAB1 EA2/EAB2 EA3/EAB3 EA4/EAB4						
COMPATIBLE WITH:	EA1/EAB1 EA2/EAB2 EA3/EAB3 EA4/EAB4						
<p>D2 ORBITAL ATTACHMENT MAXIMUM TOOL DIAMETER 85 mm</p>  <table border="1" data-bbox="244 1073 556 1185"> <tr> <td>COMPATIBLE WITH:</td> <td>EA1/EAB1 EA2/EAB2 EA3/EAB3 EA4/EAB4</td> </tr> </table>	COMPATIBLE WITH:	EA1/EAB1 EA2/EAB2 EA3/EAB3 EA4/EAB4	<p>E ORBITAL ATTACHMENT WITH TOOL ADAPTER COUPLE MAXIMUM TOOL DIAMETER 70 mm</p>  <table border="1" data-bbox="793 1093 1105 1185"> <tr> <td>COMPATIBLE WITH:</td> <td>EA1/EAB1 EA2/EAB2 EA3/EAB3</td> </tr> </table>	COMPATIBLE WITH:	EA1/EAB1 EA2/EAB2 EA3/EAB3		
COMPATIBLE WITH:	EA1/EAB1 EA2/EAB2 EA3/EAB3 EA4/EAB4						
COMPATIBLE WITH:	EA1/EAB1 EA2/EAB2 EA3/EAB3						
<p>F1 MULTIDIRECTIONAL HEAD FOR MAGNETIC DRILL</p>  <table border="1" data-bbox="244 1420 556 1481"> <tr> <td>COMPATIBLE WITH:</td> <td>EA1/EAB1 EA2/EAB2</td> </tr> <tr> <td>Max 14 kg</td> <td></td> </tr> </table>	COMPATIBLE WITH:	EA1/EAB1 EA2/EAB2	Max 14 kg		<p>F2 ORBITAL ATTACHMENT WITH VERTICAL GUIDE FOR PRECISION ADJUSTMENT FOR LASER MARKING MACHINE</p>  <table border="1" data-bbox="793 1400 1105 1481"> <tr> <td>COMPATIBLE WITH:</td> <td>EA1/EAB1 EA2/EAB2 EA3/EAB3</td> </tr> </table>	COMPATIBLE WITH:	EA1/EAB1 EA2/EAB2 EA3/EAB3
COMPATIBLE WITH:	EA1/EAB1 EA2/EAB2						
Max 14 kg							
COMPATIBLE WITH:	EA1/EAB1 EA2/EAB2 EA3/EAB3						
<p>G1 ORBITAL ATTACHMENT MAXIMUM TOOL DIAMETER 85 mm</p>  <table border="1" data-bbox="244 1737 556 1819"> <tr> <td>COMPATIBLE WITH:</td> <td>EA1/EAB1 EA2/EAB2 EA3/EAB3</td> </tr> </table>	COMPATIBLE WITH:	EA1/EAB1 EA2/EAB2 EA3/EAB3	<p>G2 ORBITAL ATTACHMENT MAXIMUM TOOL DIAMETER 125 mm</p>  <table border="1" data-bbox="793 1737 1105 1819"> <tr> <td>COMPATIBLE WITH:</td> <td>EA1/EAB1 EA2/EAB2 EA3/EAB3</td> </tr> </table>	COMPATIBLE WITH:	EA1/EAB1 EA2/EAB2 EA3/EAB3		
COMPATIBLE WITH:	EA1/EAB1 EA2/EAB2 EA3/EAB3						
COMPATIBLE WITH:	EA1/EAB1 EA2/EAB2 EA3/EAB3						

FURTHER ACCESSORIES

<p>(KSCEA2) WIRING SUPPORT KIT EA1-EAB1-EA2-EAB2 \varnothing MAX 29 mm</p> <p>(KSCEA3) WIRING SUPPORT KIT EA3-EAB3-EA4-EAB4 \varnothing MAX 29 mm</p> 	<p>(SFP120) WALL MOUNTING BRACKET Max weight 20 Kg</p> 
<p>(MCA001) TROLLEY 850X750 H=870 mm</p> <p>In painted steel with storage for tools 4 turning wheels, 2 with brake. Weight 65 kg</p> 	<p>(CPA001) TROLLEY WITH STRUCTURAL ALUMINIUM PLAN With caves for clamping pieces 800x640 h=870 mm Lower shelf in steel, 4 turning wheels, 2 with brakes. Weight : 55 Kg</p> 
<p>(CCF100) TROLLEY 800X800 mm With base of 30 mm Central column for arm support h=1000 mm 4 turning wheels, 2 with brakes</p> <p>Weight 165 kg</p> 	<p>(CCF100-1) TROLLEY 800X800 mm with base of 30 mm, central column for arm support with adjustable height from 650 mm to 1050 mm, 4 turning wheels, 2 with brakes. Weight 165 Kg</p> 
<p>(CCF100-EAM) TROLLEY 800X800 mm with 30 mm base, central arm support column with adjustable height from 650 mm to 1050 mm, 4 turning wheels 2 with brakes. Weight 185 kg (Low wheels)</p> 	<p>(CCM001) TROLLEY WITH BASE 800X800X30 mm Complete with lifting column arm h=2000 mm movement on linear guide and trapezoidal bar piloted with electric or pneumatic screwdriver 4 turning wheels, 2 with brake push handle. Weight 220 Kg</p> 
<p>(CCM001-EAM) TROLLEY 800X800X30 mm Complete with lifting column arm h=1920 mm movement on linear guide and trapezoidal bar piloted with electric or pneumatic screwdriver supports for 4 turning wheels, 2 with brake Push handle. Weight 240 Kg (Low wheels)</p> 	<p>(CF001) LIFTING COLUMN ARM H=1850 mm movement on linear guide and trapezoidal bar, piloted with electric or pneumatic screwdriver. Weight 60 Kg</p> 
<p>(CS001) TROLLEY WITH BASE 800X800X30 mm movement on 2 turning wheels with brake, 2 fixed, push handle. Weight 155 Kg.</p> 	<p>(TDS2000) LINEAR SLIDE GUIDE Total length 2200 mm Working stroke 2000 mm with self-supporting structure and 4 adjustable stabilizers. Weight: Kg.120</p> 

Notes

| Notas | Appunti | Notes

-

-

-

-

-

-

-

-

-

-

-

Some of our clients

| Alguns dos nossos clientes | Alcuni dei nostri clienti | Algunos de nuestros clientes |
Certains de nos clients

Horeca Equipments



Industrial and Agricultural Vehicles



Power transmission



Automotive



Aeronautics



Small Appliance



E-Commerce & Warehouse



Elevators



We Build Lean

4Lean, Lda
4lean@4lean.net
www.4lean.net

Some of our clients

| Alguns dos nossos clientes | Alcuni dei nostri clienti | Algunos de nuestros clientes |
Certains de nos clients

White goods

POLIDORO
by arredo3

sisme

METEOR
by arredo3

Whirlpool

Electrolux

FABER

Bicycles

SRAM

Maias

Micanda
The European Bike Fundamentals

rte

ALUBIKE

Campagnolo

LOMBARDO
CC S&B

ORBEA

Electrical

ABB

CAME

bticino

efacec

OSRAM

WESTRAFO

EFAPEL

SIEMENS

simon

Electronics

ALFA
ELECTRONICS

TE
TECHNOLOGIES

flex

KEMET
a YAGEO company

CAREL

OLYMPUS

vision-box

VISHAY

ES
ELECTRONICS

CARDIOLINE

Fashion

LVMH
LUXURY MODERNISME

NIKE

YSL

YKK

SWATCH GROUP

BALLY

KERING

Process Industry

Nestlé

BANCO DE PORTUGAL
SEGURIDADE

NAVIGATOR
LOGISTICS

Coca-Cola

thyssenkrupp

PESCANOVA

Tetra Pak

Recipharm
good for business

Ventilation and refrigeration

VERTIV.

Parker

Swegon

EBT

kide

TROX[®] TECHNIK
The art of handling air

arneg

Keyter

WoodWorking

IKEA

ALF

BRUGNOTTO
GROUP

PIANCA

Arredo3

ernestomeda

TECNOFORM

Valcucine

Industrial Machines

+GF+
GEORG FISCHER

GEA
TECHNOLOGIES

magic
MAGN APPLICAZIONI

BOBST

salvagnini

MEGA

FRIUL
INTAGLI

WAGNER

We Build Lean

4Lean, Lda
4lean@4lean.net
www.4lean.net

Some of our clients

| Alguns dos nossos clientes | Alcuni dei nostri clienti | Algunos de nuestros clientes |
Certains de nos clients

Services



Healthcare



Construction Components



Coachworks



HandTools



Public Sector



We Build Lean

4Lean, Lda
4lean@4lean.net
www.4lean.net